

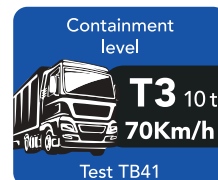

SHARK Temporary barrier

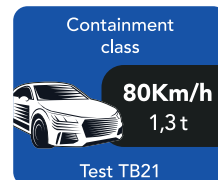
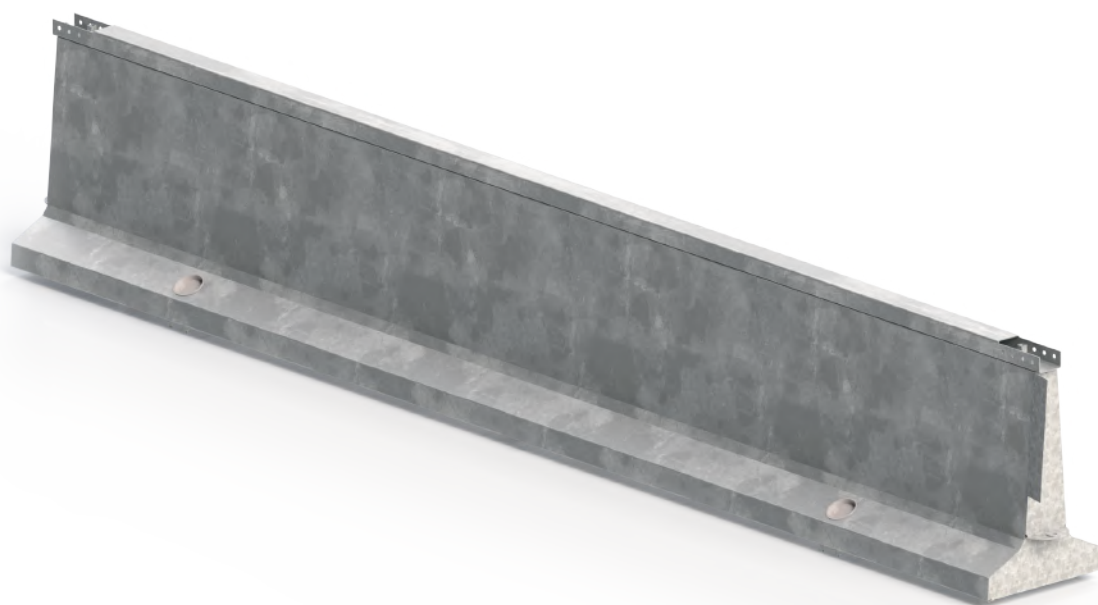

Characteristics

Containment Level: **T3** Impact Severity: **A**
 Working Width: "W" [m]: **0,8/W2**
 Dynamic Deflection: "Dn" [m]: **0,20**
 Vehicle Intrusion: "Vin" [m]: **0,70/VI2**
 Installation Type: **Asfalto**

Durability

Galvanized steel in accordance with EN ISO 1461

For further information (video, manuals, technical drawings, documentation)
 visit directly: www.ticopter.it

"Shark" temporary barrier is specifically designed for the protection of construction site areas on any type of road or motorway. The system consists in metal modules with a length of 6.00m and with a shape similar to New Jersey ET100 concrete. Successful crash tests (**TB21 and TB41**) prove that the device meets the requirements indicated by the European standard UNI EN 1317-1 and 2: 2010. It is classified with containment level **T3** and working width **W2**.

Main features

- Extremely **compact and resistant** both during installation / assembly and during transport and positioning;
- **Quick and certified installation** on asphalt with ground constraints mainly in the beginning and end of the barrier;
- **Possibility of moving** the barrier according to site needs without a crane, but with the only use of the wheels and trolley with which each module is equipped;
- The **limited dynamic deflection** during an impact with heavy vehicles allows its installation even in conditions of the reduced width of the carriageway, ensuring adequate protection of the construction site areas;
- **Possibility of integration** with any type of upper protection (dust shield, net...).

Safety device specifications

- Module length: 6000mm
- System width: 630mm
- System height: 1000±50mm

- ① Module L=6000mm
- ① F-Shape barrier Profile
- ② Stiffening Elements
- ③ Wheel Assembly
- ④ Shark for asphalt installation
- ⑤ Joint/Splice Assembly

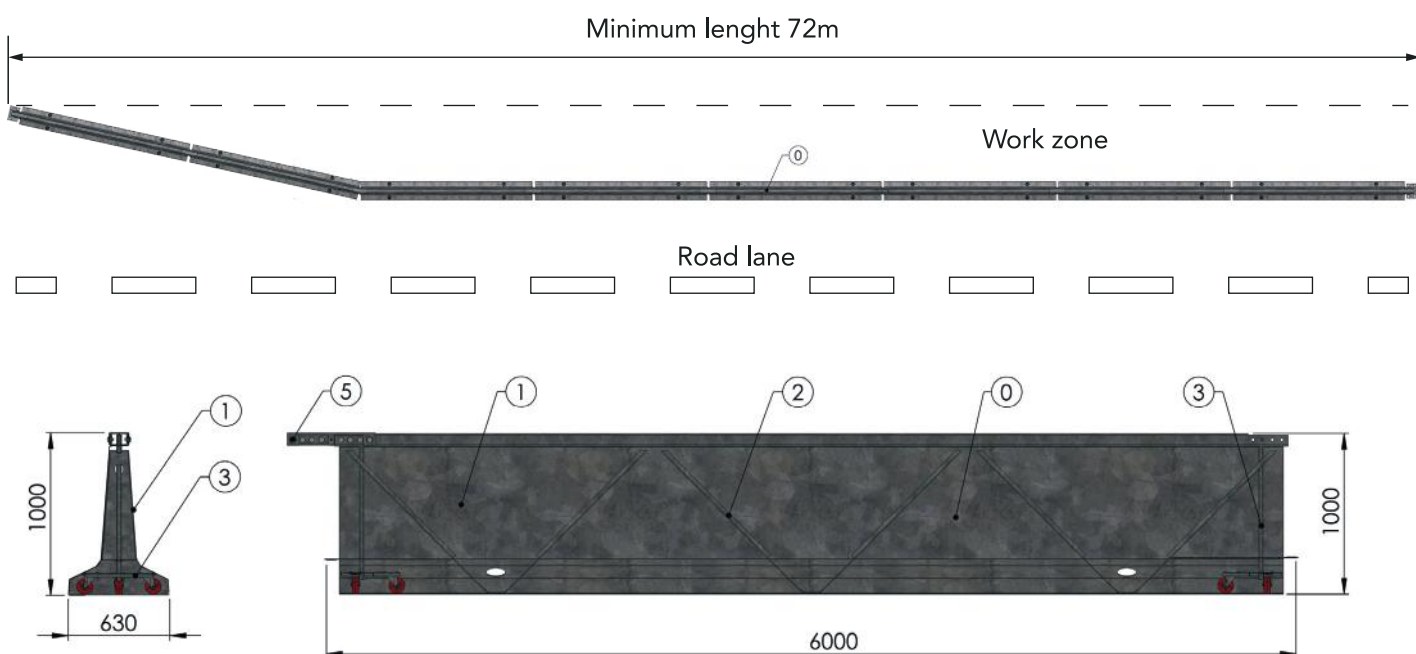

* **Shark** can be installed for a length **equal or greater** than the total length of the device indicated.